



# JT Windows, Inc.

*“Quality Crafted Windows and Doors Since 1978”*

---

## INSTRUCTIONS FOR CARE AND FINISHING OF WOOD DOORS AND WINDOWS

➤ Stile & Rail Doors

➤ Wood Windows

The following suggestions are designed to give the users of our products assistance in gaining maximum satisfaction and product life. Over 70% of all product problems are caused by improper or inadequate painting or finishing it is strongly suggested that these instructions be followed or warranty is voided.

\* Exterior wood doors and windows are only as good as their finish.

### RECEIVING YOUR ORDER:

- Immediately inspect for correctness and damage or defect. Notify your supplier at once of any problem.
- Failure to give immediate notice of error or defect negates later claims.

### HANDLING:

- Avoid skidding or sliding on floor as this can split or chip the bottom edges and corners
- Avoid leaning on steep angle as this causes damage to bottom edges.
- Do not drag one product over another as this can cause gouging and scarring damage.
- Large size or heavy windows should not be handled by one person. Racking and twisting will damage the product.
- Great care must be used in loading and hauling doors and windows. Be sure proper cover doors or panels are used. Watch for sharp or rough projections on truck bodies. Take care in tying to avoid excessive or uneven pressure or rope damage.

### STORAGE:

- Store in a clean, dry room.
- Abnormal humidity, dampness, heat, dryness or rapid changes in same must be avoided.
- All faces, edges, ends must be primed if prolonged storage is intended.
- Doors should be stacked flat on a level surface with stickers top, middle, and bottom of pile.
- Windows may be leaned against a flat, dry surface in a nearly vertical position. Take care to avoid twist or excessive pressure on product.

### FITTING:

- Examine for correctness and quality prior to cutting the product.
- Excessive cutting or fitting or the application of hardware will impair product strength and usefulness and limit claims for defective service.
- Operating doors and windows should be fitted with adequate clearance. Remember to allow for damp weather swelling.
- Normal door fitting clearance is 1/ 8 inch on the hinge side and on the lock side.
- Use care in cutting to avoid chipping. Select fine tooth saw. All sharp edges should be eased with sandpaper to avoid chipping or splintering.
- Exterior doors to 7-0 high use 3 hinges. Use 4 hinges or 7-0 high.
- Interior doors require 3 hinges except for hollow core doors weighing less than 50 lbs. or 6-8 or less in height. Doors over 7-6 high require 4 hinges.
- Exterior doors should be provided with projecting overhang for weather protection.
- Your government has dictated the use of inferior plastic glazing materials in many doors. To be safe, mask entire plastic panel area to avoid damage from paints, thinners, solvents, cleaners. Clean and wash with mild detergent or plastic cleaner.

### What Happens When Not Properly Finished:

- Wood rot
- Splitting
- Swelling - which can cause cracked glass and poor operation
- Joint splits and gaps
- Wood cracking
- Glass failure – condensation between insulated glass

## FINISHING

### STILE AND RAIL DOORS:

- Check panel alignment – one or two panels may need realignment. Tap into place using soft wood block and hammer. Back bed any stop-glazed lights with putty. See Detail B, below.
- Sand out or fill and sand any blemishes. Sand with the grain. Ease any sharp edges caused by fitting.
- Finish sand with 5/0 sandpaper and clean and dust thoroughly.
- For Paint Finish:
  - Apply good grade oil base primer according to manufacturer's instructions. Lacquer based primer or sealers should not be used.
  - Apply 2 coats of oil or latex resin-base finish paint. Care should be given to select finishes designed and manufactured to be used in combination.
  - Note: All surfaces must be fully painted – 2 faces, 2 edges, top and bottom

### WARNING!

- Stains and clear finishes are not recommended for exterior use as they weather rapidly resulting in poor wood protection.
- Stains and clear wood finishes require recoating as often as once a year.

## FINISHING

### WOOD WINDOWS AND SASH:

- Touch up putty work as required.
- Fill and sand any dings, gouges or voids.
- Sand all faces and barwork with care given to avoid scratching glass.
- Dust and wipe clean.
- Prime all wood and putty surfaces lapping paint onto glass for weather seal. Priming must be completed prior to any exposure to the weather.
- A good grade oil base primer should be used in accordance

PAINT ON TO GLASS FOR WEATHER SEAL

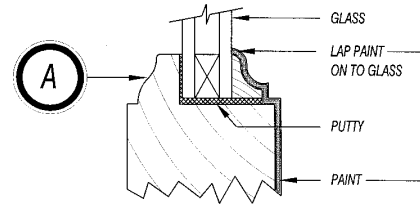

- with the manufacturer's instructions.
- Apply 2 coats of high-grade exterior trim paint according to manufacturer's directions.
- Be certain that window cleaners do not cut into the area where paint laps onto glass beyond 1/16 inch above putty. THE PAINT IS THE SEAL and must protect all wood and putty from moisture.
- Stains have proven ineffective in protecting wood windows and sash. They should be used only by an extremely few, highly experienced professional painters. Use stain finish only at your own risk as we assume no responsibility for products so finished.
- If double hung windows stick from paint, do not lift on center of check rail as it may separate from glass causing product damage.

### DOORS, WINDOWS OR SASH GLAZED WITH STOPS

Inspect around each light of glass to assure that a solid line of putty exists. Where voids exist, back putty with putty knife using good grade of putty. Be sure to cover putty by lapping paint onto glass to insure a weathertight seal.

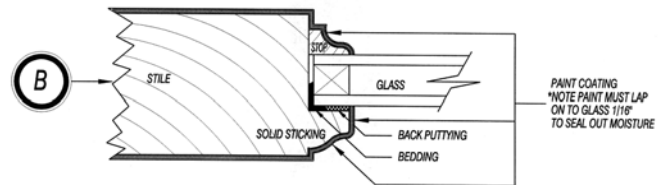

~~GLAZED DOORS: Government Regulations dictate the use of Tempered Glass or Plastic Lites. Such Glass has etched labels and tong marks near the edge of each lite as a standard. Non-marked Clear Glass is available at higher cost. We recommend masking each light prior to painting to protect from painting or cleaning damage.~~  
THANK YOU!

Our employees and owners wish to thank you for selecting one of our many quality products. We sincerely hope you are pleased with your selection and that you will specify a JT product the next time you have need.

*Again We Thank You*

JT WINDOWS, INC.



**JT Windows, Inc.**

*Quality Crafted Window & Doors*

[www.jtwindows.com](http://www.jtwindows.com)

**Since 1978**